

1P  
2008  
卷一

PROGRAM & ABSTRACT BOOK





18th International Visual Field & Imaging Symposium

May 21-24, 2008

PROGRAM & ABSTRACT BOOK







## International Perimetric Society

*Perimetry is the quantitative evaluation of the visual field. The aim of the IPS is "To promote the study of normal and abnormal visual function in the entire visual field, and to ensure and facilitate the cooperation and friendship of scientists of different countries working and interested in this discipline."*



### Previous Symposia

1974: Marseilles, France  
1976: Tübingen, Germany  
1978: Tokyo, Japan  
1980: Bristol, UK  
1982: Sacramento, CA, USA  
1984: Santa Margherita Ligure, Italy  
1986: Amsterdam, The Netherlands  
1988: Vancouver, Canada  
1990: Malmö, Sweden  
1992: Kyoto, Japan  
1994: Washington, D.C., USA  
1996: Würzburg, Germany  
1998: Gardone Riviera, Italy  
2000: Halifax, Canada  
2002: Stratford upon Avon, UK  
2004: Barcelona, Spain  
2006: Portland, OR, USA

## Table of Contents

<b>Welcome to Nara</b>	<b>2</b>
<b>Committees and Honorary Members</b>	<b>3</b>
<b>Meeting Information</b>	<b>4</b>
<b>Floor Plan</b>	<b>5</b>
<b>Social Events</b>	<b>6</b>
<b>General Information</b>	<b>7</b>
<b>Map of Downtown Nara</b>	<b>8</b>
<b>Program at a Glance</b>	<b>9</b>
<b>IPS Lecture</b>	<b>10</b>
<b>Aulhorn Lecture</b>	<b>11</b>
<b>Scientific Program</b>	<b>12</b>
<b>Sponsors</b>	<b>17</b>
<b>Abstracts</b>	<b>20</b>





# Welcome to Nara

## Dear Colleagues & Friends:

It is my great pleasure to welcome you to the 18th Visual Field Symposium of the International Perimetric Society, IPS 2008. To date, the IPS symposium has been held twice in Japan: the 3rd IPS was held in Tokyo in 1978 and the 10th IPS was held in Kyoto in 1992. Through the IPS meetings, we have been witnesses to the remarkable development of perimetric and imaging technology in the past 30 years.



Our host city for IPS 2008, Nara City, was Japan's first capital and remains a beautiful and ancient city dotted with numerous temples and shrines of great historical significance. Most of these are located within the extensive grounds of Nara Park. The city is symbolized by the delightful presence of more than one thousand deer, regarded as messengers of the gods, who roam freely in the park. Located in the center of Nara Park is Nara Prefectural New Public Hall, the venue of IPS 2008. The symposium will take place in a traditional Noh Theatre that serves as a multipurpose facility within the public hall.

The Program Committee has prepared an excellent scientific program. The fifth IPS lecture, presented by Professor Fritz Dannheim, is entitled "The Evolution of the Optic Disc Analysis: Past, Presence and Outlook". The special presentation for the Aulhorn Lecture will be given by Professor Anders Heijl and is entitled "How Better Perimetry Can Improve Glaucoma Management". As part of the social program, we will offer a guided walking tour of Nara Park that includes the most important sites, Todaiji Temple and Kasuga Taisha Shrine.

In addition to the scientific and social programs, we will have exhibit booths and featured presentations at the sponsored morning and luncheon seminars. The Society is grateful to all the sponsors. Their tremendous support and cooperation have helped in putting together all the components of a successful meeting.

We encourage you to take full advantage of this opportunity to meet and develop relationships with the finest professionals in the field amid the unique atmosphere of IPS 2008. At the same time, we invite you to enjoy the renowned attractions of beautiful Nara City.

Nara City and I welcome you to Japan!

*Chota Matsumoto*

Chota Matsumoto, M.D.  
IPS 2008 Local Host  
Department of Ophthalmology  
Kinki University School of Medicine  
Japan Perimetric Society





# Committees and Honorary Members

## Executive Committee

President:

Michael Wall, MD, Iowa City, IA, USA

Vice President:

Chris Johnson, PhD, Iowa City, IA, USA

Vice President:

Chota Matsumoto, MD, Osaka-Sayama, JAPAN

Secretary:

David Henson, PhD, Manchester, England, UK

Treasurer:

Ulrich Schiefer, MD, Tübingen, GERMANY

## Program Committee

David Henson, PhD, Manchester, England, UK

Michael Wall, MD, Iowa City, IA, USA

Chota Matsumoto, MD, Osaka-Sayama, JAPAN

Aiko Iwase, MD, Gifu-Tajimi, JAPAN

## IPS Board Members

Paul Artes, PhD

Paolo Brusini, MD

Fritz Dannheim, MD

Shaban Demirel, PhD

Ted Garway-Heath, MD

Francisco Goni, MD

Ron Harwerth, PhD

Aiko Iwase, MD

Richard Mills, MD

Pamela Sample, PhD

Yoshio Yamazaki, MD

Linda Zangwill, PhD

Mario Zulauf, MD

## Honorary Members of the IPS

Prof. Stephen Drance

Prof. Jay Enoch

Prof. Franz Fankhauser

Prof. Erik Greve

Prof. Yoshiaki Kitazawa

## In Memoriam Honorary Members of the IPS

Prof. Elfriede Aulhorn

Prof. Alan Friedmann

Prof. Hans Goldmann

Prof. Heinrich Harms

Prof. Harutake Matsuo

Prof. Mario Zingirian

## Local Organizing Committee

Host

Chota Matsumoto, MD, Osaka-Sayama, JAPAN

## Local Executive Committee

Aiko Iwase, MD

Koichi Maruyama, MD

Tadashi Nakano, MD

Sachiko Okuyama, MD

Hiroataka Suzumura, MD

Genichiro Takahashi, MD

Yoshio Yamazaki, MD

## Advisory Board

Kazutaka Kani, MD

Kenji Kitahara, MD

Yoshiaki Kitazawa, MD

Toshifumi Otori, MD

## Advisory Steering Board

Yoshikazu Shimomura, MD

## JPS Board Members

Haruki Abe, MD

Nariyoshi Endou, MD

Naoya Fujimoto, MD

Masanori Inoue, MD

Youichi Inoue, MD

Satoshi Kashii, MD

Harumi Katsushima, MD

Syujii Maeda, MD

Yozo Miyake, MD

Kuniyoshi Mizokami, MD

Yasuhiro Nishida, MD

Motohiro Shirakashi, MD

Shiroaki Shirato, MD

Goji Tomita, MD

Keiji Yoshikawa, MD

Takeshi Yoshitomi, MD



# Meeting Information

## Venue

### Nara Prefectural New Public Hall

101 Kasugano-cho, Nara City, Japan 630-8212

Phone: +81-742-27-2630

Fax: +81-742-27-2634

## Official Language

English (English-Japanese simultaneous interpretation provided)

## Registration

On-Site Registration Fees are:

IPS Members..... 60,000 JPY

Non Members ..... 70,000 JPY

Residents/Fellows\* ..... 45,000 JPY

Accompanying Persons..... 45,000 JPY

\* Residents/Fellows must submit an official university certificate or letter, in conjunction with their registration, which confirms their status. Documentation must come from a supervisor, or department head.

## Registration Entitlement

### For IPS Members, Non Members, Residents/ Fellows

- Congress Kit, including a set of official publications
- All Scientific Programs/Exhibition
- Welcome Party on May 21
- "Shikayose" (Deer Gathering) on May 23
- "Noh" Performance on May 23
- Conference Tour on May 23
- Closing Banquet on May 24
- Morning/Luncheon Seminars
- Coffee Breaks

## For Accompanying Persons

- Welcome Party on May 21
- "Shikayose" (Deer Gathering) on May 23
- "Noh" Performance on May 23
- Conference Tour on May 23
- Closing Banquet on May 24
- Coffee Breaks

## Registration Desk

The registration desk for the meeting is located in the lobby on the first floor of the Nara Prefectural New Public Hall. Registration desk opening hours are:

May 21 12:00-18:00

May 22 8:00-17:30

May 23 8:00-13:30

May 24 8:00-17:30

## Name Badge

All registered attendees will receive a name badge. Please wear the badge for all meeting activities.

## General Information Desk

Inquiries concerning the meeting may be made at the general information desk located next to the registration desk.

## Tour Desk

Inquiries concerning hotel accommodations, transportation or accompanying persons' programs may be made at the tour desk, located near the registration desk.





# Floor Plan Nara Prefectural New Public Hall

## Second Floor

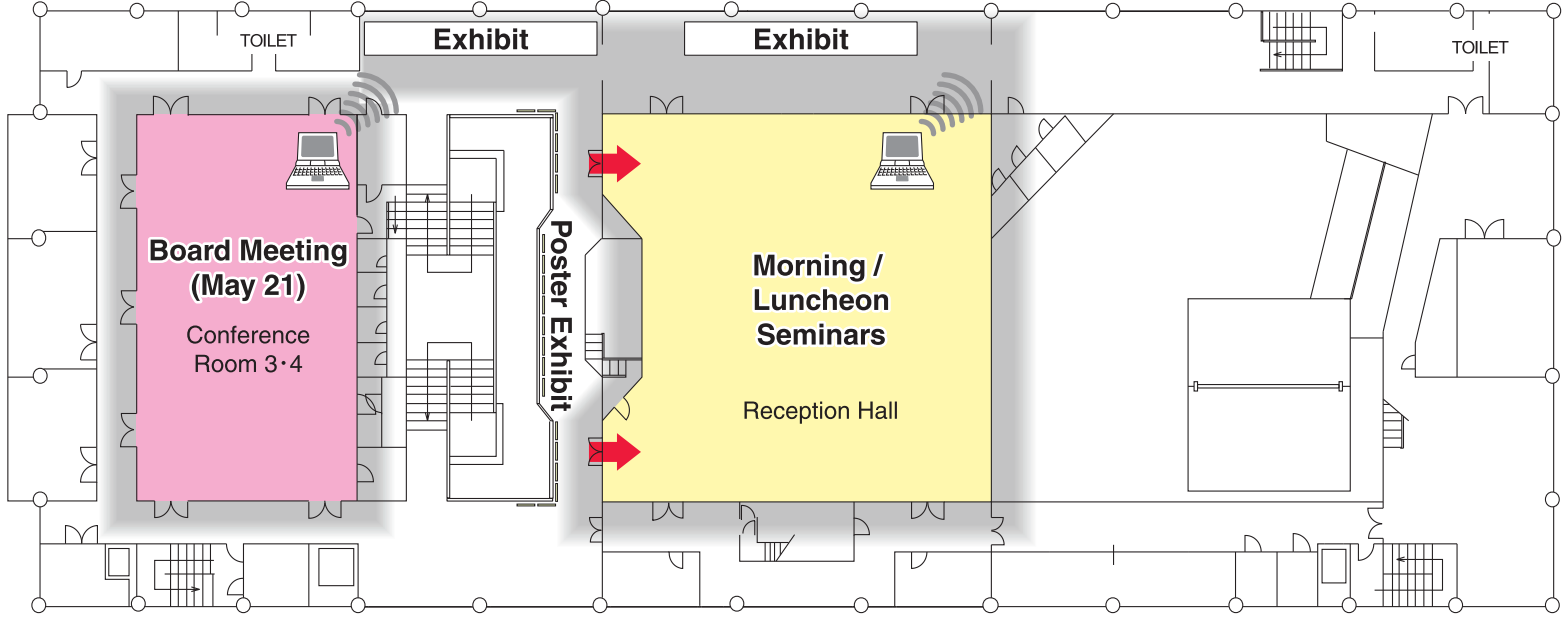

## First Floor

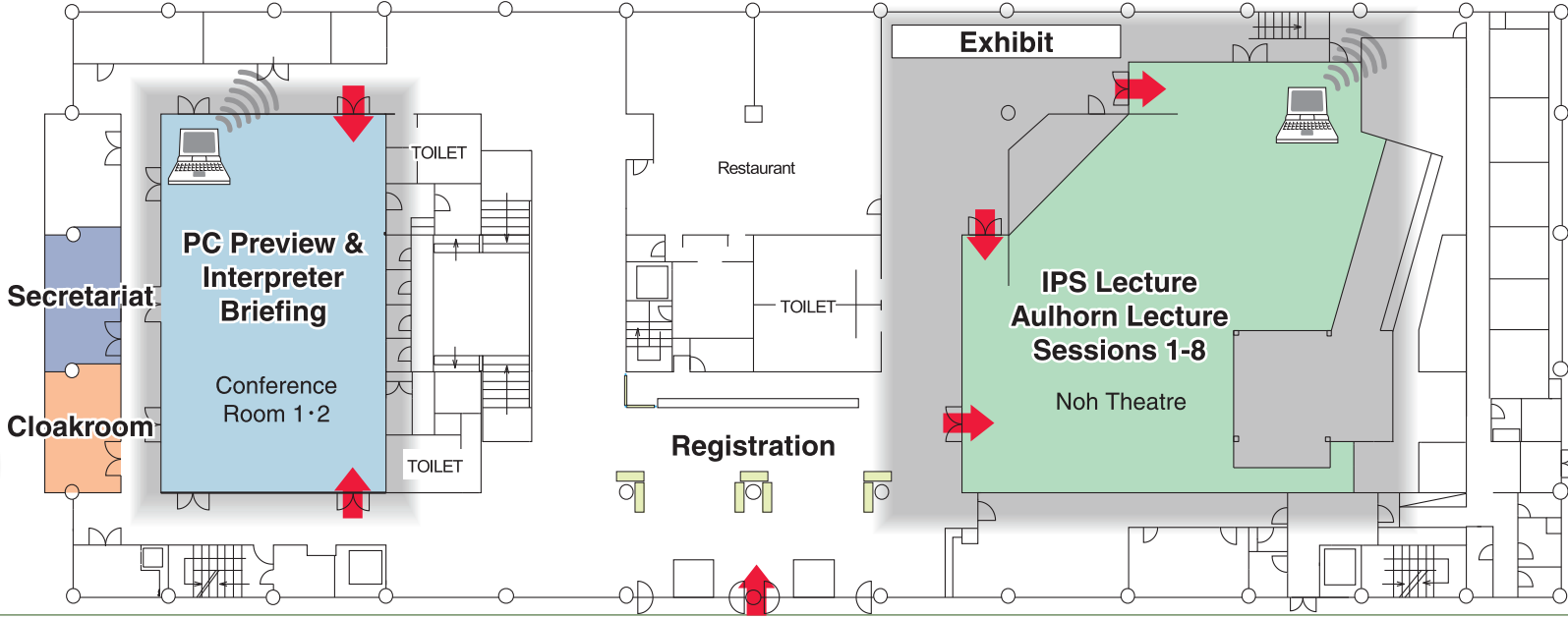



## Social Events

### Wednesday, May 21

#### Welcome Party

**Time:** 17:30-19:30

**Location:** Nara Prefectural New Public Hall

**Fee:** included

**Dress:** Casual

Welcome Party will be held in a beautiful garden of Nara Prefectural New Public Hall. Let the networking begin whilst you enjoy food and drink. Fee is included in registration. The party is open to all food and drink registered participants.

### Thursday, May 22

#### Japanese Dinner

**Time:** 18:00-

**Location:** Heijo

**Fee:** 13,000 JPY

**Dress:** Casual

Seats are limited in number and are available on a first-come-first-served basis.

You can enjoy a wide variety of traditional Japanese dishes in a tatami-mat room full of atmosphere.

Shuttle bus services will be provided to and from the event sites.  
(See page 8 for details.)

### Friday, May 23

#### "Shikayose" (Deer Gathering)

**Time:** 7:30-7:50

**Location:** Tobihino, Nara Park

**Fee:** included

With a French horn tone, many deer will flock from various quarters. The event of Deer Gathering dates from 1892.

#### "Noh" Performance

**Time:** 13:10-13:40

**Location:** Nara Prefectural New Public Hall

**Fee:** included

Noh is a traditional Japanese performing art which developed in the 14th century.

#### Walking Tour in Nara Park

**Time:** 13:50-

**Location:** Todaiji Temple (Daibutsuden Hall, Nigatsudo Hall), Kasuga Taisha Shrine

**Fee:** included

**Dress:** Casual

The local organizing committee offers a guided walking tour of Nara Park. The tour is included in the registration fee and is open to all registered participants.

### Saturday, May 24

#### Closing Banquet

**Time:** 19:00-

**Location:** Banquet Room HITEN, Hotel Nikko Nara

**Fee:** included

**Dress:** Smart Casual

Closing Banquet will be held at Hotel Nikko Nara as a finale to IPS 2008.

Following the meal, we will enjoy the traditional national singing. Fee is included in registration. The banquet is open to all registered participants.





# General Information

## **Banks**

Banks are open from Monday to Friday, 9:00-15:00 (Closed on Saturdays, Sundays and national holidays). Some automatic teller machines (ATMs) are available for cash withdrawal by credit card everyday (except national holidays) from 9:00 to 19:00 at almost all major banks.

## **Climate**

The temperature in Nara in May typically ranges between 20-25 degrees centigrade during the day.

## **Credit Cards**

Visa, MasterCard, American Express, and Diners Club cards are widely accepted at hotels, department stores, shops, and restaurants as well as at major train stations.

## **Currency**

Most currencies and traveler's checks can be exchanged at international airports, large branches of major banks, and hotels. A passport may be required for currency exchange services.

## **Electricity**

100 volts alternating current at a frequency of 60 Hz. is used in western Japan.

## **Insurance**

The Organizing Committee will assume no liability whatsoever for injury or damage to persons or property during the Congress. Please make your own arrangements for health insurance and any other necessary insurance.

## **Postal Service**

Hotels often provide simple postage services. Post offices are open from Monday to Friday, 9:00 to 17:00.

## **Time**

Japan Standard Time is 9 hours ahead of UTC (Coordinated Universal Time).

## **Tipping and Consumption Tax**

Tipping is not customary in Japan. However, major restaurants or hotels may add a 10% to 15% service charge to your bill. A 5% sales tax is already included in the prices shown.



# Map of Downtown Nara

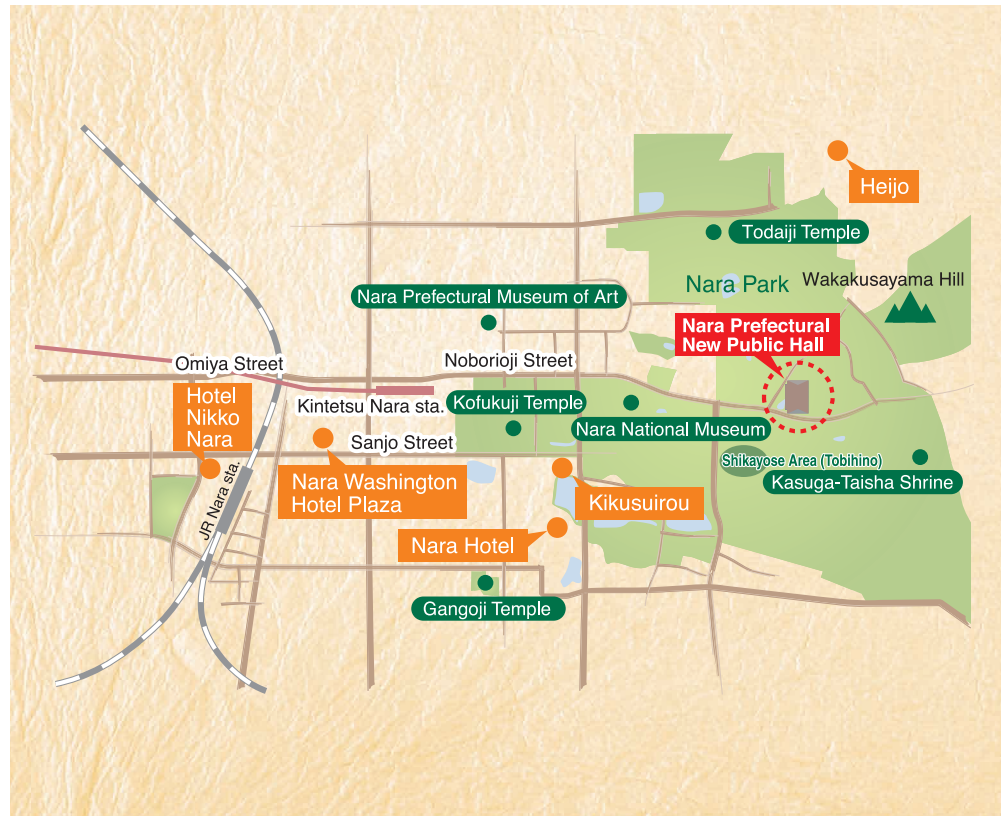

## Symposium Venue:

Nara Prefectural New Public Hall

## From Hotel Nikko Nara / Nara Washington Hotel Plaza

A 40-minute walk or a 15-minute ride by taxi

## From Nara Hotel

A 15-minute walk or a 10-minute ride by taxi

## Shuttle Bus Services

### Wednesday, May 21

<b>To Symposium Venue:</b> (For Welcome party)	Nara Hotel → Nara Prefectural New Public Hall <b>17:00</b> → <b>17:10</b>
	Hotel Nikko Nara → Nara Prefectural New Public Hall <b>17:00</b> → <b>17:15</b>
<b>From Symposium Venue:</b>	Nara Prefectural New Public Hall → Nara Hotel <b>20:15</b> → <b>20:25</b>
	Nara Prefectural New Public Hall → Hotel Nikko Nara <b>20:15</b> → <b>20:30</b>

### Thursday, May 22

<b>To Symposium Venue:</b>	Nara Hotel → Nara Prefectural New Public Hall <b>7:45</b> → <b>7:55</b>
	Hotel Nikko Nara → Nara Prefectural New Public Hall <b>7:40</b> → <b>7:55</b>
<b>From Symposium Venue:</b>	Nara Prefectural New Public Hall → Nara Hotel <b>17:45</b> → <b>17:55</b>
	Nara Prefectural New Public Hall → Hotel Nikko Nara <b>17:45</b> → <b>18:00</b>
<b>From Symposium Venue to Japanese Dinner Venue:</b>	Nara Prefectural New Public Hall → Japanese Dinner* <b>17:35</b> → <b>17:55</b>

\* After Japanese Dinner, buses will be provided to Nara Hotel/Hotel Nikko Nara.

### Friday, May 23

<b>To Shikayose (Deer Gathering) Area**:</b>	Nara Hotel → Shikayose (Deer Gathering) <b>7:05</b> → <b>7:15</b>
	Hotel Nikko Nara → Nara Prefectural New Public Hall <b>7:00</b> → <b>7:15</b>
<b>To Symposium Venue:</b>	Nara Hotel → Nara Prefectural New Public Hall <b>7:45</b> → <b>7:55</b>
	Hotel Nikko Nara → Nara Prefectural New Public Hall <b>7:40</b> → <b>7:55</b>
<b>From Symposium Venue:</b>	Nara Prefectural New Public Hall → Nara Hotel <b>17:40</b> → <b>17:50</b>
	Nara Prefectural New Public Hall → Hotel Nikko Nara <b>17:40</b> → <b>17:55</b>

\*\*Shikayose area is within walking distance of Nara Prefectural New Public Hall.

### Saturday, May 24

<b>To Symposium Venue:</b>	Nara Hotel → Nara Prefectural New Public Hall <b>7:45</b> → <b>7:55</b>
	Hotel Nikko Nara → Nara Prefectural New Public Hall <b>7:40</b> → <b>7:55</b>
<b>From Symposium Venue to Closing Banquet Venue:</b>	Nara Prefectural New Public Hall → Nara Hotel → Hotel Nikko Nara <b>17:40</b> → <b>17:50</b> → <b>18:35</b> → <b>18:50</b>
	Nara Prefectural New Public Hall → Hotel Nikko Nara <b>17:40</b> → <b>17:55</b>
<b>From Closing Banquet Venue:</b>	Hotel Nikko Nara → Nara Hotel <b>21:30</b> → <b>21:45</b>

- Those who stay at Nara Washington Hotel Plaza, please take the buses departing and arriving at Hotel Nikko Nara.

- The bus schedule is subject to change depending on the event schedule.



# Program at a Glance

## Wednesday, May 21

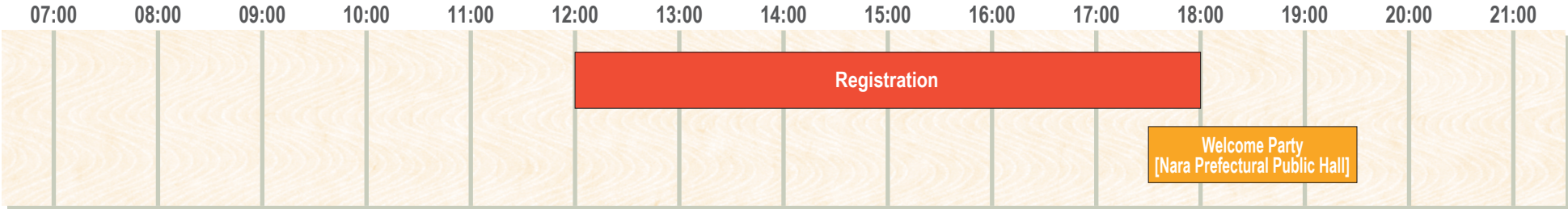

## Thursday, May 22

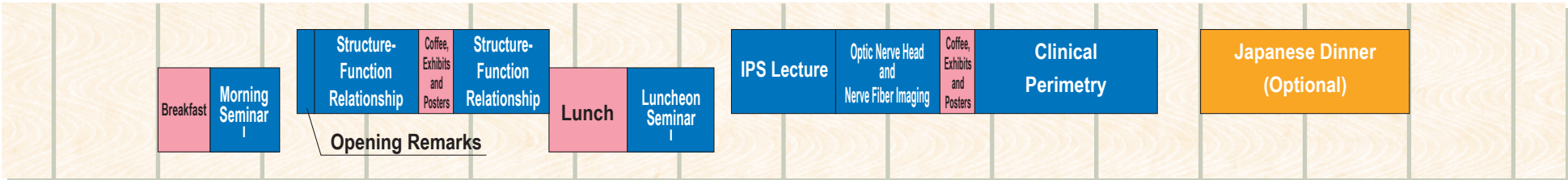

## Friday, May 23

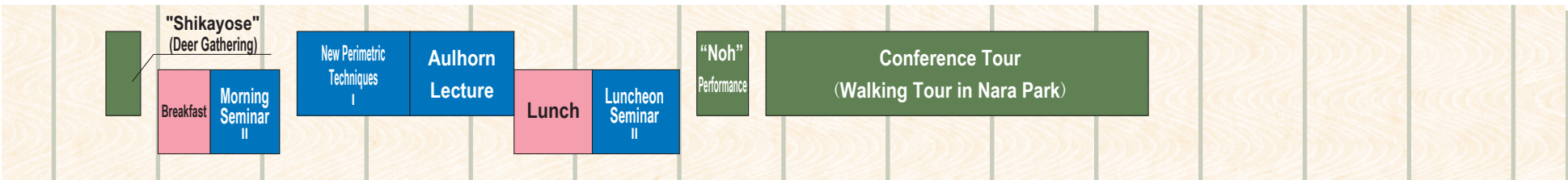

## Saturday, May 24





# IPS Lecture: Fritz Dannheim M.D.

Thursday, May 22 13:30-14:30

Prof. Dannheim was born in 1942 in Stuttgart, southern Germany. He received his medical training in Munic and Tuebingen, and wrote his thesis in 1968 with Prof. Aulhorn on dark adaptation in the visual field. Following a fellowship with Professor Stephen Drance in Vancouver from 1968-69, he served as a resident at the Military Hospital Hamburg, the Dept. of Neurology at the General Hospital Hamburg-Harburg, and the University Eye Departments at Tuebingen and at Hamburg in 1972. Since becoming Assistant Professor in ophthalmology in 1985, Prof. Dannheim has held special interest in glaucoma, neuro-ophthalmology, perimetry, retinology and imaging. From 1995, he has been serving as a consultant at the General Hospital Hamburg-Harburg and practicing in the neighbourhood.



Since the first IPS symposium was held in 1974, Prof. Dannheim not only has participated in every IPS meeting but also had served as a Board Member of the IPS. Undoubtedly, he is the true witness to the history of the society and has made substantial contribution to the society meetings. His talk will be entitled "The Evolution of the Optic Disc Analysis: Past, Presence and Outlook."

---

## The Evolution of the Optic Disc Analysis: Past, Presence and Outlook

Chairperson: Michael Wall

Fritz Dannheim

*Asklepios Hospital Hamburg-Harburg & Outpatient Unit Seevetal, GFR*

Digital assessment of the optic disc has become indispensable for high-grade management of glaucoma. This contribution illustrates the historical evolution of this technology from photography, stereophotography, stereo-chronoscopy, manual planimetry, photogrammetry, videographic stereoanalysis to the current laserscanning and OCT devices. An outlook tries to sketch new developments for further improvements in favour of reliable glaucoma management.





# Aulhorn Lecture: Anders Heijl M.D., Ph.D.

Friday, May 23 10:25-11:25

Prof. Heijl is a graduate of Lund University Medical School where he also completed his residency in ophthalmology. He received a Ph.D. from Lund University in 1977 for his early work on computerized perimetry, and later completed a post-doctoral fellowship under the mentorship of Professor Stephen Drance at the University of British Columbia. Since 1990, Prof. Heijl has served as Chairman at the Department of Ophthalmology, Malmö University Hospital, Lund University, Sweden.

Between 1980 and 1996, Prof. Heijl served the IPS first as Scientific Secretary and later as President. From 1992, he has also served as Study Director of the Early Manifest Glaucoma Trial that he initiated. Since 2003, he serves as President of the Glaucoma Research Society, until recently known as the Glaucoma Society of the International Congress of Ophthalmology, and as the chief ophthalmological advisor to the Swedish National Board of Health and Welfare.

Prof. Heijl and his research group have invented and developed the Statpac programs for the Humphrey perimeter, including the now widely used concepts of Probability Maps, Pattern Deviation, Change Probability Maps, the Glaucoma Hemifield Test and the Glaucoma Progression Analysis programs. The Swedish Interactive Thresholding Algorithm (SITA) was also developed and adapted to Standardized Automated Perimetry and to Short Wavelength Automated Perimetry (SWAP) in his laboratory.

Prof. Heijl has published more than 170 scientific papers, chapters and books. He has served as Editor-in-Chief of Acta Ophthalmologica, and on the editorial boards of eight ophthalmic journals. Prof. Heijl has received scientific awards, or delivered invited name lectures on many occasions.

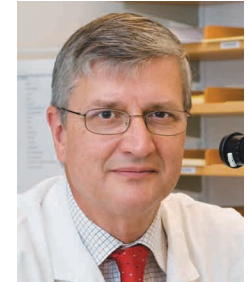

## How Better Perimetry Can Improve Glaucoma Management

Chairperson: David B. Henson

Anders Heijl

*Department of Ophthalmology, Malmö University Hospital, Lund University*

The large glaucoma RCTs have shown that glaucoma progression rates vary very much between patients. The RCTs have also clarified the important risk factors for glaucoma progression. But even using those factors we now know that the disease course in individual patients cannot be predicted. IOP reduction has been shown to be highly effective, but progression is the rule also in treated patients with IOP levels within normal statistical limits who have been followed for a long time. Really low IOP levels are associated with considerably smaller risk of progression, but are not attainable without a large cost in side-effects and complications. Tonometry alone is, therefore, never sufficient, regardless of IOP levels; in glaucoma management we must always follow and quantify glaucoma damage. Treatment goals in glaucoma management are expressed in terms of visual function, and structural test can, therefore, never replace visual function tests (perimetry), at least as long as we do not have way of translating structural findings to visual function.

Perimetry is under-utilized today. Studies have shown that often visual fields are obtained with long intervals, sometimes as long as two years. Analyses of data from EMGT show that the frequency of testing is of pivotal importance to detect glaucoma progression within a reasonable time frame. A recently published analysis of the influence of test frequency on the ability to identify rapidly progressive eyes show that an average of three fields per year for two years is needed to find eyes that progress by 2dB/years.

Perimetry is also badly understood by many clinicians. Many ophthalmologists do not understand the usage of available computer-assisted analyses and many are unaware of, and therefore do not use, existing software for following glaucoma progression. Misconceptions about perimetry are common: perimetry is often erroneously thought to more difficult than it is, impossible for elderly patients or patients with low visual acuity et cetera. Negative attitudes and poor instruction of patients can threaten the quality of perimetric results, while trials have shown that with good instructions and reasonable support almost all patients are able to produce informative and reliable test results, that can be used not only for diagnosis but also to follow the disease course reliably.

More and better perimetry could prevent a lot of glaucoma disability. We have an educational duty visavi our colleagues and a political duty to ensure appropriate reimbursement of perimetry, the most important tool in glaucoma management.

1. Chauhan B, Garway-Heath DF, Goni FJ, Rosetti L, Bengtsson B, Wiswanatah AC, Heijl A. Practical recommendations for measuring rates of visual field change in glaucoma. Br J Ophthalmol 2008 Jan 22 [Epub ahead of print].





# Scientific Program

## Wednesday, May 21

12:00-18:00 Registration

17:30- Welcome Party at Garden

## Thursday, May 22

8:00-8:30 Breakfast at Reception Hall

### Morning Seminar I 8:30-9:10 Reception Hall

New Generation In Structure And Function For Glaucoma Management — The New Humphrey Visual Field Analyzer With Guided Progression Analysis And Newly Featured Optical Coherence Tomographers, Stratus OCT And Cirrus HD-OCT

Carl Zeiss Meditec Co., Ltd.

Chairperson: *Aiko Iwase*

**New Glaucoma Applications For Optical Coherence Tomography**  
*Vincent Michael Patella*

**Effective Use Of Perimetry In Glaucoma Management**  
*Anders Heijl*

### Opening Remarks 9:20-9:30 Noh Theatre

### Session 1 9:30-11:45 Noh Theatre

#### Structure-Function Relationship

Moderators: *Linda Zangwill and Ronald S. Harwerth*

9:30- **1-01**  
**A Structure-Function Map Derived From Medmont Perimetric Data**  
*Andrew Turpin*

9:45- **1-02**  
**Quantifying Concordance Between Structure And Function Measurements In The Clinical Assessment Of Glaucoma**  
*Haogang Zhu*

10:00- **1-03**  
**Relationship Between Functional And Structural Changes In Glaucoma Suspects And Early Glaucoma Patients**  
*Hiroki Nomoto*

10:15- **1-04**  
**Structure-Function In Glaucoma: A New Hypothesis**  
*Marta Gonzalez-Hernandez*

10:30-10:50 Coffee, Exhibits and Posters

10:50- **1-05** Poster  
**The Threshold Values In MATRIX Reflect The Nerve Fiber Layer Thickness In Early Glaucoma Patients**  
*Katsuhiko Maruyama*

10:55- **1-06** Poster  
**Ability Of OCT To Detect Localized Retinal Nerve Fiber Layer Defects In Patients With Normal Standard Automated Perimetry Results**  
*Shinji Ohkubo*

11:00- **1-07**  
**Longitudinal Changes In Structure And Function: Results From The Diagnostic Innovations In Glaucoma Study (DIGS)**  
*Linda Zangwill*

11:15- **1-08**  
**Nonlinear And Linear Models For Predicting Structure From Function In Glaucoma**  
*Ronald S. Harwerth*





# Scientific Program

11:30- 1-09  
**How Do Psychophysical Estimates Of Ganglion Cell Sampling Density Relate To Structural Measurements At The Optic Nerve Head In The Normal Ageing Eye?**  
*Tony Redmond*

11:45-12:30 Lunch at Reception Hall

**Luncheon Seminar I 12:30-13:20 Reception Hall**  
**Ocular And Brain Changes In Glaucoma Monkey Models**  
**Santen Pharmaceutical Co., Ltd.**

Chairperson: *Chota Matsumoto*

**Changes Of The Visual System In A Monkey Model Of Glaucoma**  
**- Structural Changes In Retina And Optic Nerve Head**  
*Masaaki Sasaoka*

**Changes Of The Visual System In A Monkey Model Of Glaucoma**  
**- Lateral Geniculate Nucleus And Visual Cortex**  
*Ronald S. Harwerth*

**IPS Lecture 13:30-14:30 Noh Theatre**

Chairperson: *Michael Wall*

**The Evolution Of The Optic Disc Analysis: Past, Presence And Outlook**  
*Fritz Dannheim*

**Session 2 14:30-15:30 Noh Theatre**

**Optic Nerve Head And Nerve Fiber Imaging**

Moderators: *Paul Artes and Goji Tomita*

14:30- 2-01  
**Biological Shape Models Of Optic Nerve Topography In Patients With Glaucoma And Healthy Controls**  
*Paul Artes*

14:45- 2-02  
**Interpretation Of Optic Disc Images For Glaucomatous Damage: Reference Data From Specialists**  
*Jonathan Denniss*

15:00- 2-03 **Poster**  
**Performance Of Glaucoma Probability Score Classification (GPSC) In Glaucoma Screening With HRTII: Comparison With Moorfield's Regression Analysis (MRA)**  
*Hisashi Takeda*

15:05- 2-04  
**A New Method For Evaluating Stereometric Data From The Heidelberg Retinal Tomograph (HRT3)**  
*Allison McKendrick*

15:20- 2-05 **Poster**  
**Agreement Of Structural Abnormality By Heidelberg Retina Tomography And Optical Coherence Tomography In Ocular Hypertensive And Glaucomatous Eyes**  
*Ryo Asaoka*

15:25- 2-06 **Poster**  
**Inner Retinal Layer Measurements With Fourier Domain Optical Coherence Tomography And Its Correlation With Optic Disc Topography Measured By Heidelberg Retina Tomography In Glaucomatous Eyes With Hemifield Defects**  
*Goji Tomita*

15:30-15:50 Coffee, Exhibits and Posters

**Session 3 15:50-17:35 Noh Theatre**

**Clinical Perimetry**

Moderators: *Ulrich Schiefer and Aiko Iwase*

15:50- 3-01  
**Pre-anatomic And Pre-perimetric Glaucoma**  
*Manuel Gonzalez de la Rosa*

16:05- 3-02  
**The Diagnostic Ability Of Anderson Criteria On Glaucomatous Visual Field Defects In Eyes With Myopic- And Nonmyopic-Type Optic Disc**  
*Tairo Kimura*

16:20- 3-03  
**Test-Retest Differences Of The Visual Field In Retinitis Pigmentosa**  
*Chris Johnson*

16:35- 3-04  
**Little Recovery Of Visual Field Defect In The Ischemic Retina In Branch Retinal Artery Occlusion**  
*Hiroyuki Iijima*

16:50- 3-05  
**Perception Of Metamorphopsia Under Monocular And Binocular Conditions Evaluated By M-CHARTS And AMSLER CHARTS In Patients With Macular Diseases**  
*Eiko Arimura*

17:05- 3-06  
**Evaluation Of Full-Field Sensitivity Test (FFST) Measures For Clinical Trials And Relationship To Wayfinding**  
*Ronald Schuchard*

17:20- 3-07 **Poster**  
**Central Visual Field Changes In Myopic Glaucoma With Optic Disc Ovality**  
*Rishu Inoue*

# Scientific Program

- 17:25- 3-08 **Poster**  
**Scotopic, Mesopic, And Photopic Perimetry In Acute Zonal Occult Outer Retinopathy**  
*Kazuki Kuniyoshi*
- 17:30- 3-09 **Poster**  
**Objective Visual Field Evaluation Using Multifocal Visual Evoked Potentials In Patients With Intracranial Disease Complicated By Mental Disorder**  
*Eiichi Yukawa*
- 18:00- Japanese Dinner (Optional) at Heijo

## Friday, May 23

7:30-7:50 "Shikayose" (Deer Gathering)

8:00-8:30 Breakfast at Reception Hall

### Morning Seminar II 8:30-9:10 Reception Hall

#### HAAG-STREIT AG

**The Role And Potential Of Kinetic Perimetry - Current And Future Developments**  
*Ulrich Schiefer*

**Fully Automated Kinetic Perimetry With Computer-Simulated Virtual Patients**  
*Chota Matsumoto*

### Session 4 9:20-10:25 Noh Theatre

#### New Perimetric Techniques I

**Moderators:** *Chris Johnson and Chota Matsumoto*

9:20- 4-01  
**Age-Corrected Normative Data For The Entire (90°) Visual Field, Assessed With Full Threshold Automated Static Perimetry And A Fast Thresholding Algorithm (GATE)**  
*Ulrich Schiefer*

9:35- 4-02 **Poster**  
**Quantitative Assessment Of The Visual Field Loss Due To Retinitis Pigmentosa Using Semi-automated Kinetic Perimetry**  
*Katarzyna Nowomiejska*

9:40- 4-03  
**Comparison Between Semi-automated Kinetic Perimetry (SKP) And Fully Automated Kinetic Perimetry (AKP = Program K) In Patients With Visual Field Loss**  
*Shigeki Hashimoto*

9:55- 4-04  
**Influence Of Media Opacities On Flicker Perimetry**  
*Chota Matsumoto*

### Aulhorn Lecture 10:25-11:25 Noh Theatre

Chairperson: *David B. Henson*

**How Better Perimetry Can Improve Glaucoma Management**  
*Anders Heijl*

11:25-12:10 Lunch at Reception Hall

### Luncheon Seminar II 12:10-13:00 Reception Hall

**Alcon Japan Ltd.**

Chairperson: *Yoshiaki Kitazawa*

**Normal Tension Glaucoma: Clinical Challenges And New Therapeutic Concepts**  
*David S. Greenfield*

13:10-13:40 "Noh" Performance at Noh Theatre

13:50- Walking Tour in Nara Park



# Scientific Program

## Saturday, May 24

8:00-8:30 Breakfast at Reception Hall

### Morning Seminar III 8:30-9:10 Reception Hall

Topcon Corporation

Chairperson: *Makoto Araie*

**Three-Dimensional Visualization And Thickness Mapping Of RNFL Using SD OCT**  
*Yijun Huang*

### Session 5 9:20-10:10 Noh Theatre

Analysis Of Visual Field Data

Moderators: *Richard P. Mills and Michael Wall*

9:20- **5-01** Poster  
**A Comparison Of Catch Trial Methods Used In Conventional Perimetry In Glaucoma Patients**  
*Carrie Doyle*

9:25- **5-02**  
**Use Of A Continuous Probability Scale To Display Visual Field Damage**  
*Michael Wall*

9:40- **5-03** Poster  
**Area-Threshold Curves Obtained Using Various Objects**  
*Tsuyoshi Yoneda*

9:45- **5-04** Poster  
**Influence Of Ocular Optical System Aberrations In Perimetry, Especially For Peripheral Vision Measurement**  
*Genichiro Takahashi*

9:50- **5-05**  
**How Do Different Test Strategies For Estimating Perimetry Thresholds Behave When The Dynamic Range Of Measurement Varies?**  
*Ciara Bergin*

10:05- **5-06** Poster  
**Risk Factors For Progressive Visual Field Loss That Threatens Fixation**  
*Sanae Kanno*

10:10-10:30 Coffee, Exhibits and Posters

### Session 6 10:30-11:50 Noh Theatre

Comparisons Of Perimetric Tests

Moderators: *Fritz Dannheim and Genichiro Takahashi*

10:30- **6-01** Poster  
**Comparison Of The Retinal Sensitivities And The Global Indices In SITA Standard And Dynamic Strategies**  
*Hirotaaka Suzumura*

10:35- **6-02** Poster  
**Detectability Of Early Stage Glaucomatous Visual Field Defects In Dynamic And SITA Standard Strategies**  
*Shiro Mizoue*

10:40- **6-03**  
**Variability With Multisampling Suprathreshold Perimetry And SITA Standard Perimetry In Glaucoma**  
*Michael Horler*

10:55- **6-04** Poster  
**The Relationships Between Threshold Estimates And Effective Dynamic Ranges Of Standard Automated Perimetry (Size III And V), Motion And Matrix Perimetry**  
*Kimberly Woodward*

11:00- **6-05**  
**Conventional (Octopus G1X) And Flicker Fusion Perimetry (Pulsar) In Glaucoma: A Clinical Comparison**  
*Fritz Dannheim*

11:15- **6-06** Poster  
**Pulsar Perimetry In Diagnosis Of Early Glaucoma**  
*Marco Zeppieri*

11:20- **6-07**  
**Potential Of Frequency Doubling Technology For Earlier Detection Of Damage Than Standard Automated Perimetry In Glaucoma With Lowered Intraocular Pressure**  
*Aiko Iwase*

11:35- **6-08**  
**Comparison Of N-30 And 24-2 Threshold Programs Of Frequency Doubling Perimetry For The Evaluation Of Glaucomatous Visual Field Defect Severity**  
*Shoichi Morise*

11:50-12:35 Lunch at Reception Hall

### Luncheon Seminar III 12:35-13:25 Reception Hall

New Perspectives In Detecting Glaucoma Progression  
Pfizer Japan Inc.

Chairperson: *Yoshiaki Kitazawa*

**Detection Of, Magnitude Of And Risk Factors For Progression In The Early Manifest Glaucoma Trial**  
*Anders Heijl*

13:35-14:25 Business Meeting at Noh Theatre

# Scientific Program

## Session 7 14:25-15:30 Noh Theatre

### Progression

Moderators: *David Garway-Heath and Yoshio Yamazaki*

- 14:25- **7-01**  
**Comparison Of Analysis Methods For Progression Of Visual Field Defect**  
*Yoshio Yamazaki*
- 14:40- **7-02**  
**Detection Of Local Visual Field Deterioration In Patients With Diffuse Improvement Using Cluster Trends Analysis**  
*Sachiko Okuyama*
- 14:55- **7-03** Poster  
**The Influence Of Initial Visual Field Sensitivity On The Rate Of Visual Field Loss Over Time In Glaucoma Patients**  
*Paraskeva Hentova-Sencanic*
- 15:00- **7-04**  
**Specificity Of The Program Threshold Noiseless Trend (TNT) For Perimetric Progression Analysis**  
*Manuel Gonzalez de la Rosa*
- 15:15- **7-05**  
**Sensitivity Performs Better Than Slope At Predicting Future Progression In Early Glaucoma**  
*Stuart Gardiner*

15:30-15:50 Coffee, Exhibits and Posters

## Session 8 15:50-17:25 Noh Theatre

### New Perimetric Techniques II

Moderators: *David B. Henson and Takeshi Yoshitomi*

- 15:50- **8-01**  
**Assessing The Utility Of A Combined Suprathreshold/Threshold Procedure For Retesting Visual Fields**  
*Allison McKendrick*
- 16:05- **8-02** Poster  
**Trial Model Of Perimeter For Measuring Binocular And Monocular Visual Fields Separately While Opening Both Eyes**  
*Taketoshi Suzuki*
- 16:10- **8-03** Poster  
**Trial Model For Measuring Retinal Function By Using Sense Of Color And Form**  
*Shin Kouta*
- 16:15- **8-04** Poster  
**Measurement Of Thresholds In Normal Subjects Using Fundus-Oriented Small-Target Perimetry**  
*Yusuke Nakatani*
- 16:20- **8-05** Poster  
**The Magnitude Of Stereopsis In Peripheral Visual Fields**  
*Hiroshi Mochizuki*
- 16:25- **8-06** Poster  
**The Effect Of Correction For Central Refractive Error On Thresholds For The Moorfields Motion Displacement Test (MDT)**  
*Reza Moosavi*
- 16:30- **8-07** Poster  
**A New Short-Wavelength Automated Perimetry With Flicker Target**  
*Kazunori Hirasawa*

- 16:35- **8-08**  
**The Heidelberg Edge Perimeter: A New Method For Visual Field Assessment**  
*John Flanagan*

- 16:50- **8-09** Poster  
**Glaucomatous Visual Field In "Pupil Perimetry"**  
*Noriko Sato*

- 17:55- **8-10** Poster  
**Utility Of Pupil Perimetry In Glaucoma**  
*Ken Asakawa*

- 17:00- **8-11** Poster  
**The Head Mount Display Type Pupil Perimeter**  
*Fumiatsu Maeda*

- 17:05- **8-12** Poster  
**Evaluating Pupil Light Reflexes With Color Stimuli**  
*Keiichi Tanzawa*

- 17:10- **8-13**  
**Higher Resolution Pupillographic Multifocal Perimetry**  
*Ted Maddess*

## Closing Remarks 17:25-17:30 Noh Theatre

- 19:00- Closing Banquet at Hotel Nikko Nara



# Sponsors

## Seminar Sponsors:

Alcon Japan Ltd.  
Carl Zeiss Meditec Co., Ltd.  
HAAG-STREIT AG  
Pfizer Japan Inc.  
Santen Pharmaceutical Co., Ltd.  
Topcon Corporation

## Sponsors:

AMO Japan K.K.  
Banyu Pharmaceutical Co., Ltd.  
Bausch & Lomb Japan Co., Ltd.  
Beeline co., Ltd.  
Chiyoe Matsumoto  
CHUO SANGIO COMPANY  
Heidelberg Engineering GmbH  
HOYA Corporation  
Inami & Co., Ltd.  
Japan Focus Co., Ltd.  
Kowa Co., Ltd.  
Kowa Pharmaceutical Co., Ltd.  
Lumenis Japan Co., Ltd.

Medisoft Ltd.

MEDITAKE

Otsuka Pharmaceutical Co., Ltd.

RE MEDICAL, Inc.

Ritzmedical Co., Ltd.

R-Tech Ueno, Ltd.

Senju Pharmaceutical Co., Ltd.

Takagi Seiko Co., Ltd.

UniSAC, Inc.

## Supporting Groups:

Japan Perimetric Society

Kinki University

Nara Association of Ophthalmologists

Osaka Association of Ophthalmologists

